

# Madison II



House size: **16**sq

Block size range: **8.5m** land width / **28m** land depth

## SPECIFICATIONS

Home Width	8.50m	
Home Length	19.30m	
	<b>SQ.M</b>	<b>SQUARES</b>
Ground Floor	119.24m <sup>2</sup>	12.84sq
Garage	23.58m <sup>2</sup>	2.54sq
Porch	5.07m <sup>2</sup>	0.55sq
<b>Total</b>	<b>147.89m<sup>2</sup></b>	<b>15.92sq</b>

## DESIGN FEATURES

- Open plan living area
- Kids bedrooms in centre of house for privacy and comfort
- Private master bedroom tucked away at front of house
- Linen cupboard conveniently near laundry

## FACADE OPTIONS

All our designed facades can be adapted to this floor plan, however the below facades options are suggested by our design team.

- Botanic
- Hyde
- Griffith
- Luxembourg
- Hedgeley
- Phoenix

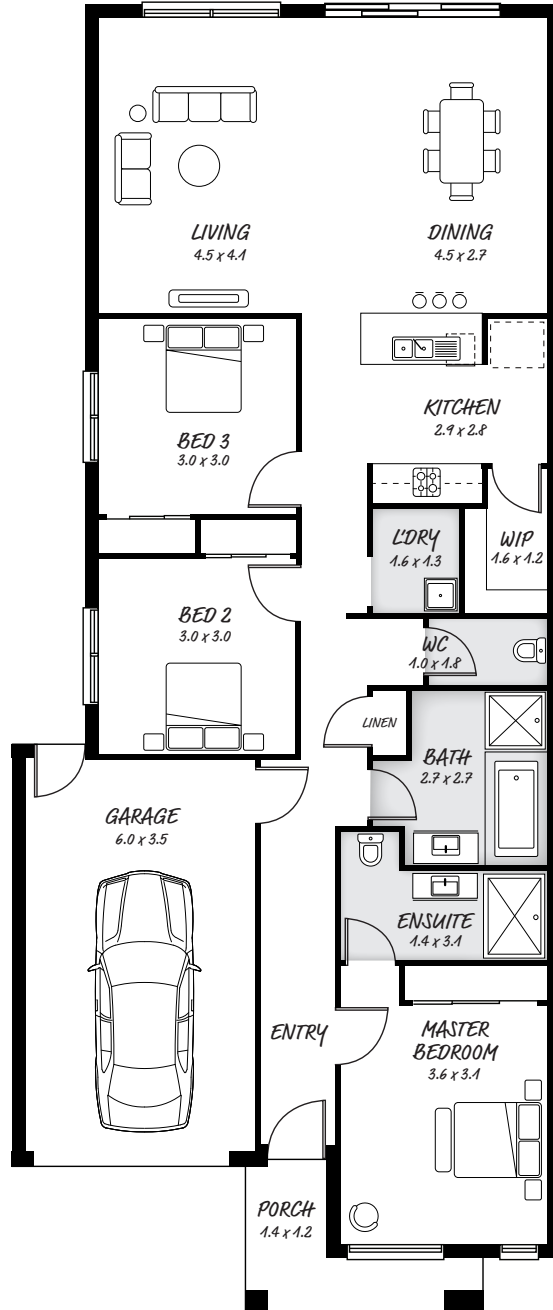

### HEAD OFFICE

5/82 Gateway Blvd, Epping 3076

Ph. 1300 060 908

email: info@astonhomes.com.au

astonhomes.com.au

Sizes may vary dependant on chosen facade. Refer to final working technical drawings for final dimensions. Facade options are only a recommendation. Ask your sales representative for what floor plan best suites certain facades.